



Advantages/Benefits

- ▶ Adjustable, in-tank fitting for up to four liquid level switches
- ▶ Switch cars may be adjusted to any depth along the entire track
- ▶ Installs through 2" G / NPT fitting
- ▶ All polypropylene construction
- ▶ Polypropylene enclosure rated IP65 with PG13 cable connector
- ▶ Available in one, two or three meter standard track lengths
- ▶ Standard track sections may be cut to any length as required
- ▶ Multi-switch installation is made both, fast and simple
- ▶ Compatible with all Burkert level switch technologies

Design/Function

Smart Trak can be installed vertically through the top wall of the tank in any 2" G or NPT fitting.

Smart Trak can be installed to the side wall of the tank using the optional side mount bracket.

Applications

- High level switch / alarm prevents tank from overfilling
- Low level switch / alarm provides both pump and immersion heater protection
- Automatic fill or empty operation maintains liquid level between two switch points
- Automatic fill or empty operation with redundant high or low level switch / alarm
- Independent high and low level switch / alarm

bürkert
Easy Fluid Control Systems

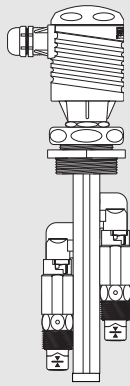

Smart Trak Fitting

Smart Trak is an in-tank, adjustable fitting for up to four liquid level switches. Once installed, the switches may be adjusted to any depth along the entire length of track.

The fitting is made of 20% glass filled polypropylene and is available in one, two or three meter lengths. The assembled Smart Trak mounts vertically through the top wall of the tank in any 2" G or NPT fitting.

Smart Trak may be installed to the side wall of the tank using the side mount bracket and is mixer compatible with rotational velocities up to 45 cm / second.

The PP enclosure is rated IP65 and provides power and signal termination for up to four switches. For integral relay control with Smart Trak, select one of Burkert's SL30 switch mount controllers. All switch mount controllers and liquid level switches are specified separately.

Smart Trak Systems

High or Low Level Switch

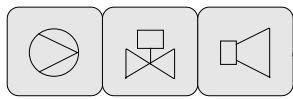

The IP65, PP junction box mounts directly on top of the 2" G or NPT plug fitting. The one, two or three meter Smart Trak section may be cut to any length as required. The single switch car is easily adjusted to any depth along the entire length of track.

Automatic Fill or Empty

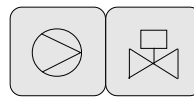

The IP65, PP junction box mounts on top of the 2" G or NPT plug fitting. The one, two or three meter Smart Trak section may be cut to any length as required. The two switch cars are easily adjusted to any depth along the entire length of track.

Automatic Fill or Empty with High or Low Level Alarm

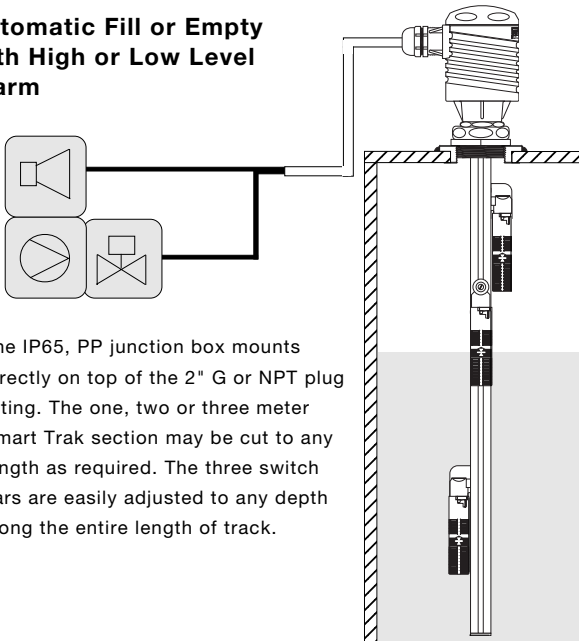

The IP65, PP junction box mounts directly on top of the 2" G or NPT plug fitting. The one, two or three meter Smart Trak section may be cut to any length as required. The three switch cars are easily adjusted to any depth along the entire length of track.

Automatic Fill or Empty with High and Low Level Alarm

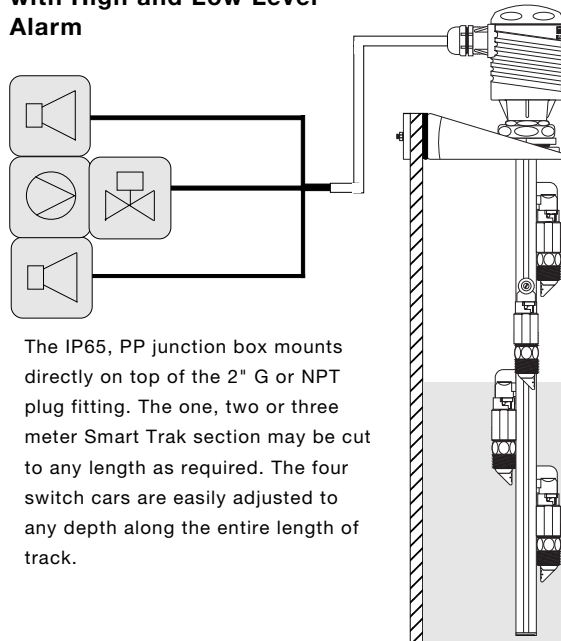

The IP65, PP junction box mounts directly on top of the 2" G or NPT plug fitting. The one, two or three meter Smart Trak section may be cut to any length as required. The four switch cars are easily adjusted to any depth along the entire length of track.

Smart Trak Dimensions

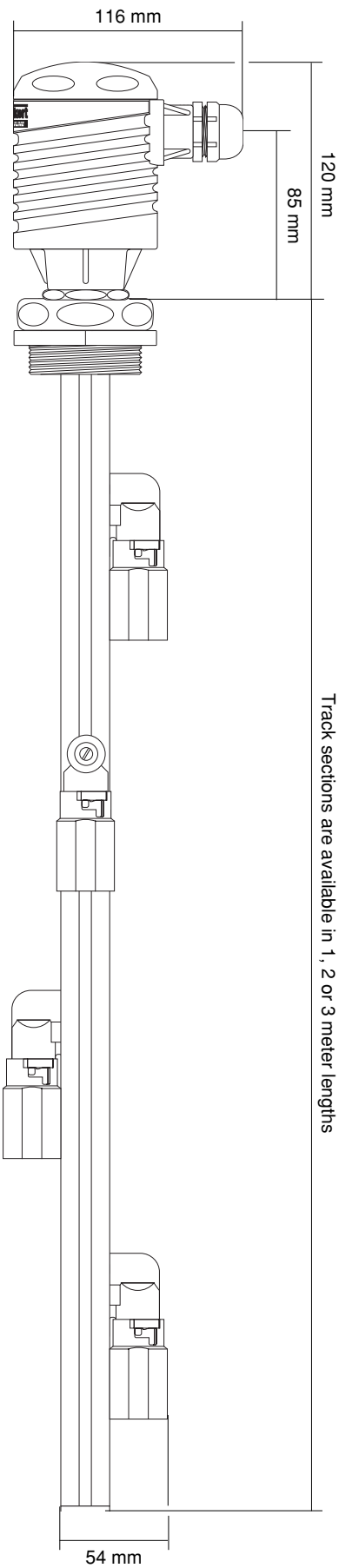

Smart Trak Assembly

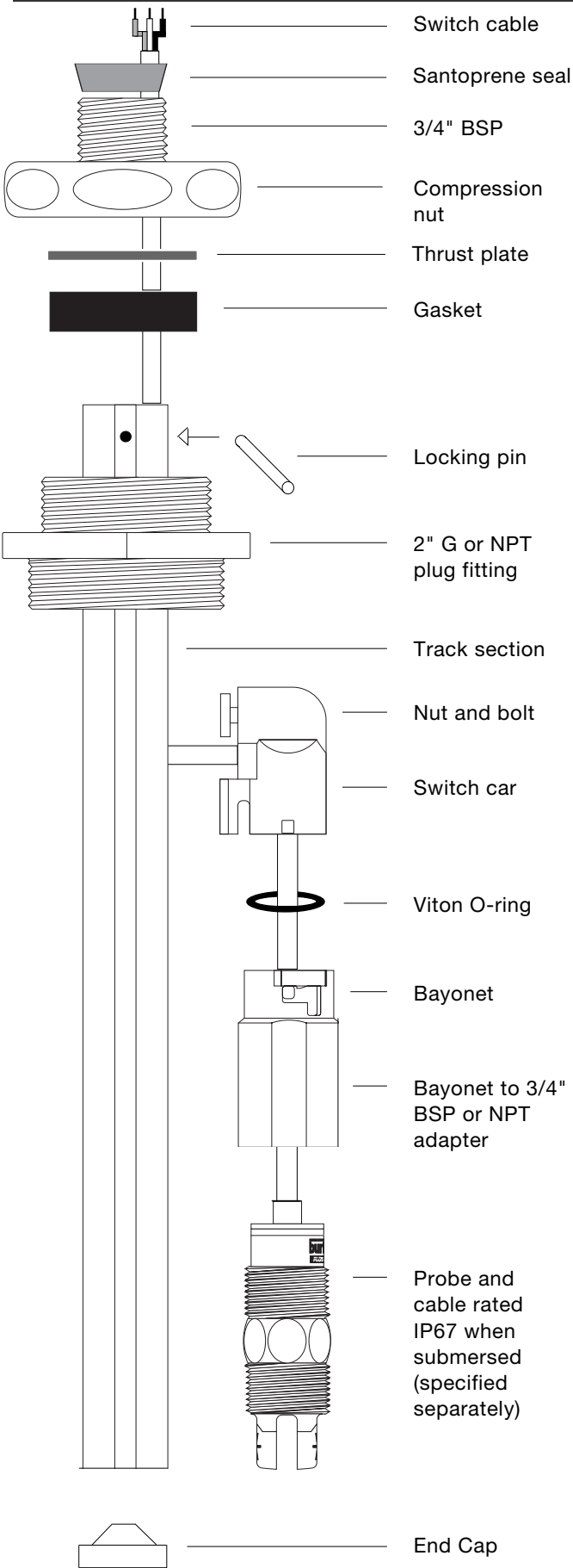

Smart Trak Technical Data

Fitting data

Track length	1, 2 or 3 meter standard length
Wetted materials	20% glass filled PP, viton O-ring
Mounting threads	Available in 2" G or NPT
Temperature rating	90 degrees C. maximum
Pressure rating	Atmospheric
Switch car adjustment	Along the entire length of track
Car attachment method	Plastic nut and bolt assembly
Bayonet adapter threads	Available in 3/4" BSP or 3/4" NPT

Junction box data

Enclosure rating	IP65 splash and chemical resistant
Enclosure material	PP flame retardant (U.L.94VO)
Temperature rating	70 degrees C. maximum
Switch termination	12 pole terminal strip for 4 switches
Cable connection	PG13 liquid-tight cable connector
Mounting threads	3/4" BSP or 3/4" NPT

Side Mount Bracket Dimensions

Bracket
Top View

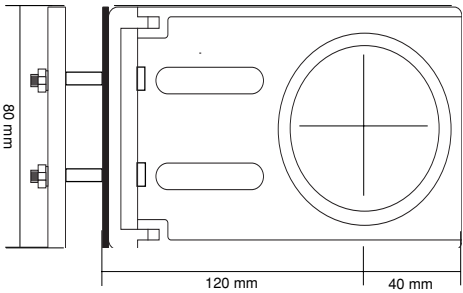

Bracket
Side View

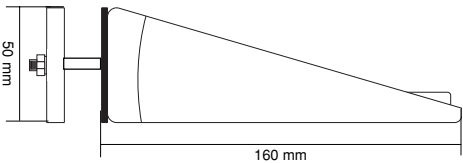

Side Mount Bracket	Order-No.
PP-Bracket with 2" G threads	417075J
PP-Bracket with 2" NPT threads	417076K

Ordering Chart (Other Versions on Request)

Terminal Box	Switch Cars	Plug Fitting	Fitting Length (m)	Specification	Order-No.
—	1	G 2"	1	SL40-F1M1	417193 E
—	1	G 2"	2	SL40-F1M2	417305 W
—	1	G 2"	3	SL40-F1M3	417306 X
—	2	G 2"	1	SL40-F2M1	417307 Y
—	2	G 2"	2	SL40-F2M2	417197 A
—	2	G 2"	3	SL40-F2M3	417199 L
—	3	G 2"	1	SL40-F3M1	417308 H
—	3	G 2"	2	SL40-F3M2	417309 A
—	3	G 2"	3	SL40-F3M3	417310 W
—	4	G 2"	1	SL40-F4M1	417311 K
—	4	G 2"	2	SL40-F4M2	417312 L
—	4	G 2"	3	SL40-F4M3	417313 M
IP65	1	G 2"	1	SL40-J1M1	417213 R
IP65	1	G 2"	2	SL40-J1M2	417314 N
IP65	1	G 2"	3	SL40-J1M3	417315 P
IP65	2	G 2"	1	SL40-J2M1	417185 E
IP65	2	G 2"	2	SL40-J2M2	417209 E
IP65	2	G 2"	3	SL40-J2M3	417316 Q
IP65	3	G 2"	1	SL40-J3M1	417317 R
IP65	3	G 2"	2	SL40-J3M2	417211 P
IP65	3	G 2"	3	SL40-J3M3	417212 Q
IP65	4	G 2"	1	SL40-J4M1	417318 S
IP65	4	G 2"	2	SL40-J4M2	417319 T
IP65	4	G 2"	3	SL40-J4M3	417320 Y

