



Advantages/Benefits

- ▶ 2 or 6 Nm torque
- ▶ Open/closed or variable speed drive
- ▶ Flange interface ISO 5211
- ▶ IP 65 rating
- ▶ Corrosion-resistant

Design/Function

The rotary actuators are compact and powerful units, which will provide a long service life.

Their design and construction make them maintenance-free even in aggressive environments and ensure a low heat load of the system.

Additional modules directly convert a standard signal input to a proportional rotation of the rotary actuator. The control input signal and power supply to the motor are electrically isolated.

Applications

Electric actuators to operate:

- Ball valves
- Butterfly valves
- Disc valves
- Ventilators
- Mixer valves, e.g. in chemical industry, water treatment, in the dosing and bottling industry.



Technical Data

Specifications

Control	<ul style="list-style-type: none"> • alternating current • direct current with changeover relay • standard interface 4-20 mA, 0-10 V
Rotation angle	90° 180°
Output torque	2 Nm 6 Nm
Rotation time	7,5 s / 90° ¹⁾ 15 s / 90°
Flange interface	ISO 5211 parts 1 and 2 or flange interface for Bürkert control valve Type 227
Body material	plastic
Ambient temperature	-20 °C to +60°C
Weight	approx. 0.8 kg

Electrical Data

Operating voltages	230 V / 50 Hz 12 V, 24 V/= 24 V/UC (universal current)									
Voltage tolerance	±10 %									
Power consumption	<table border="1"> <tr> <td></td> <td>2 Nm</td> <td>6 Nm</td> </tr> <tr> <td>AC</td> <td>4 VA</td> <td>10 VA</td> </tr> <tr> <td>DC</td> <td>5 W</td> <td>10 W</td> </tr> </table>		2 Nm	6 Nm	AC	4 VA	10 VA	DC	5 W	10 W
	2 Nm	6 Nm								
AC	4 VA	10 VA								
DC	5 W	10 W								
Duty cycle	AC 70 % intermittent operation DC 100 % continuously rated									
Electrical connection	cable plug for cable 6-7 mm ø (supplied as standard)									

¹⁾ With alternating current output torque max. 5 Nm

Symbols

Standard Versions AC

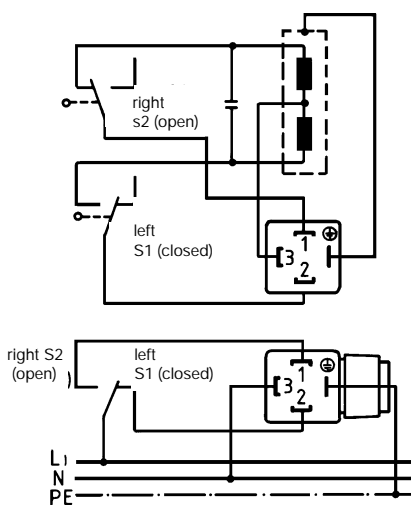

Direction of rotation with view on drive shaft

Standard Version DC

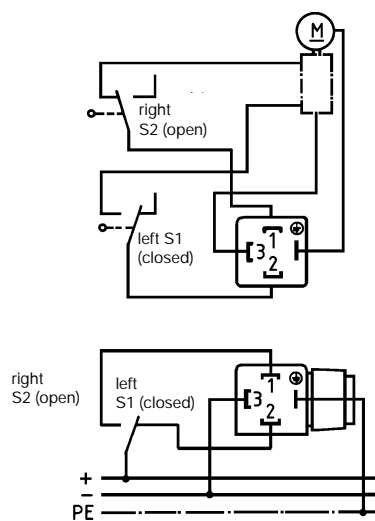

Direction of rotation with view on drive shaft

Standard Interface

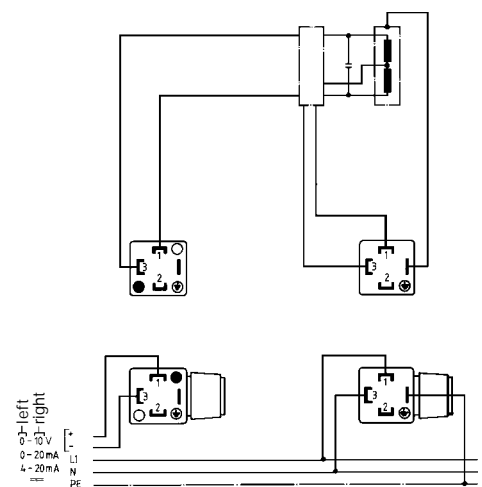

Direction of rotation with view on drive shaft

Dimensions in mm

ISO-Flange Interface

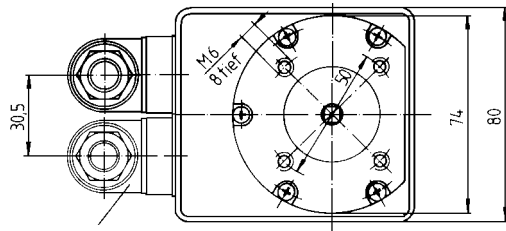

Supplementary for certain versions

Bürkert-Flange Interface

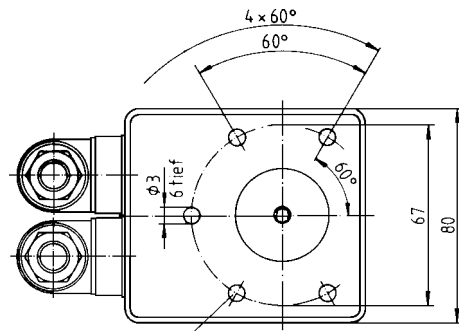

For E-jot PT-screw
KA 40 WN 1441

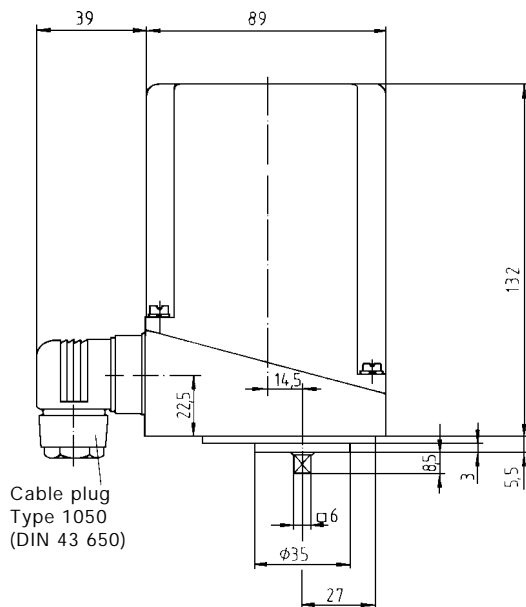

Cable plug
Type 1050
(DIN 43 650)

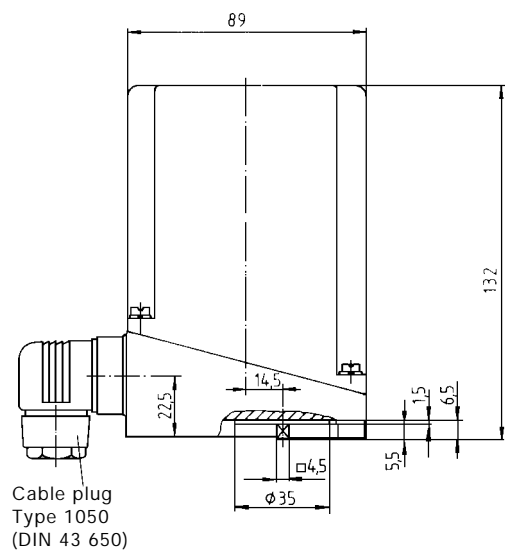

Cable plug
Type 1050
(DIN 43 650)

Ordering Chart (Other Versions on Request)

Control	Rotation Angle	Output Torque	Rotation 90° Time	Flange Interface	Voltage/ Frequency [V/Hz]	Order-No.
AC	90°	6 Nm	7,5 s	ISO 52 11	230/50	001 189 G
			15 s	ISO 52 11	230/50	000 183 S
4-20 mA	180°	2 Nm	7,5 s	Bürkert	230/50	000 316 E
			15 s	Bürkert	230/50	000 526 Z
0-10 V	180°	2 Nm	7,5 s	Bürkert	024/UC	000 637 G
DC	90°	6 Nm	7,5 s	ISO 52 11	012/=	000 219 M
	90°	6 Nm	7,5 s	ISO 52 11	024/=	006 290 B
	180°	6 Nm	7,5 s	Bürkert	024/=	000 349 X