

**REED CONTACT 2 wires •**  
**Detection of magnets •**  
**Cable output •**

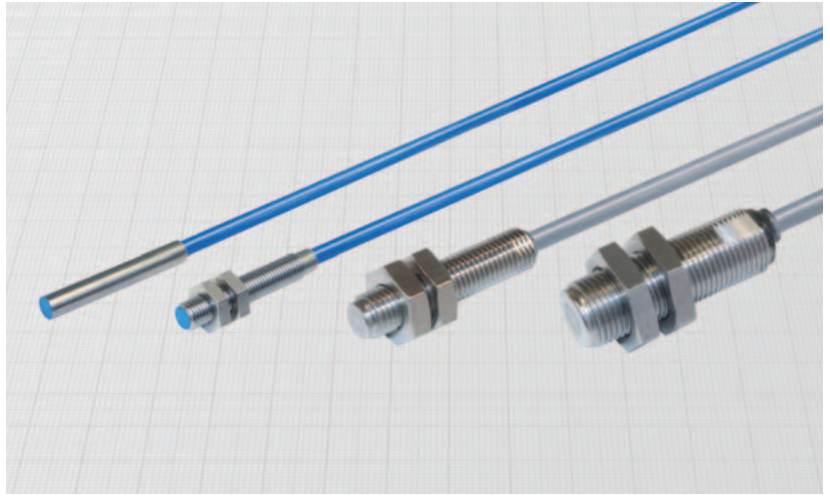
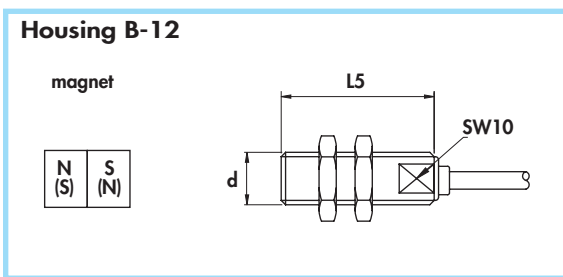
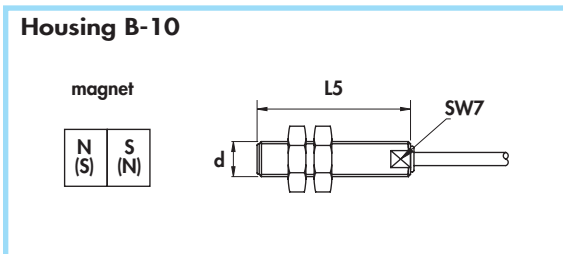
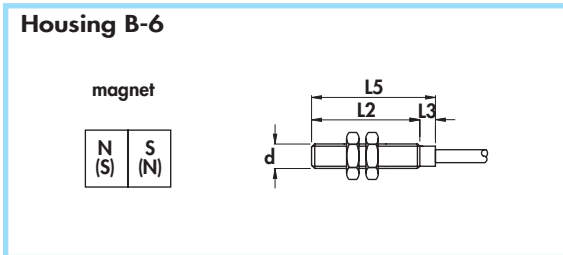
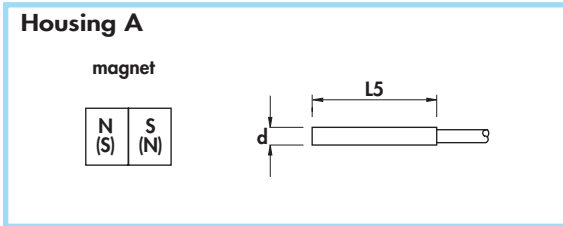

Diameter	M5 x 0,5	M8 x 1	M12 x 1
Nut	Size	SW7	SW13
	Thickness mm	2,5	4
Max tightening torque Nm	2	10	20

**Materials:**

- Cable: 2m PVC CEI 20 - 22 II; 90°C; 300 V; O.R.
- Housing: stainless steel

**General Features:**

These sensors give on the output a contact activated by an external magnetic field, not depending by the polarity of the field. The activation distance depends by the power of the magnet (see on page C-12), which must be ordered separately. Reed contacts allows to drive directly dc loads (PNP/NPN) or ac loads. Diameters 8 and 12 mm are completely in stainless steel and are able to withstand high pressures on the housing.

**Technical data:**

- Max working voltage: 50 Vac/75 Vdc normally open
- Output logic: 0,1 Ω
- Contact resistance max: 1 ms
- Operate time max: 0,4 ms
- Release time max: -25 ÷ +85°C
- Temperature range: front side (diameters 8 and 12 mm): IP68
- Degree of protection: back side: IP67
- Pressure on the front side max (diameters 8 and 12 mm): 150 bar
- Cable conductor cross section: 0,15 mm<sup>2</sup> on 4 and 5 mm
- 0,35 mm<sup>2</sup> on 6,5 ÷ 12 mm

Housing	L1	L2	L3	L4	L5	Cable diameter	Body diameter (d)	Max switching frequency (f)	Rated operational current (I <sub>e</sub> )	ORDERING REFERENCES
	mm	mm	mm	mm	mm					
A	-	-	-	-	25	3	4	0,5	500	<b>BMS4/4600L</b>
B-6	-	20	5	-	25	3	M5 x 0,5	0,5	500	<b>BMS5/4600</b>
A	-	-	-	-	30	4	6,5	0,5	500	<b>BMS6,5/4600L</b>
B-10	-	-	-	-	35	4	M8 x 1	0,5	500	<b>BMS8/4600</b>
B-12	-	-	-	-	35	4	M12 x 1	0,5	500	<b>BMS12/4600</b>

**ORDERING REFERENCES**

