

Diameter 45 mm •
Amplified in d.c. •
Connector output C1 - C2 •

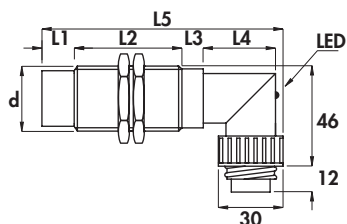

Housing M-2

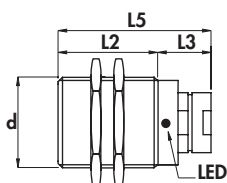

Housing M-3

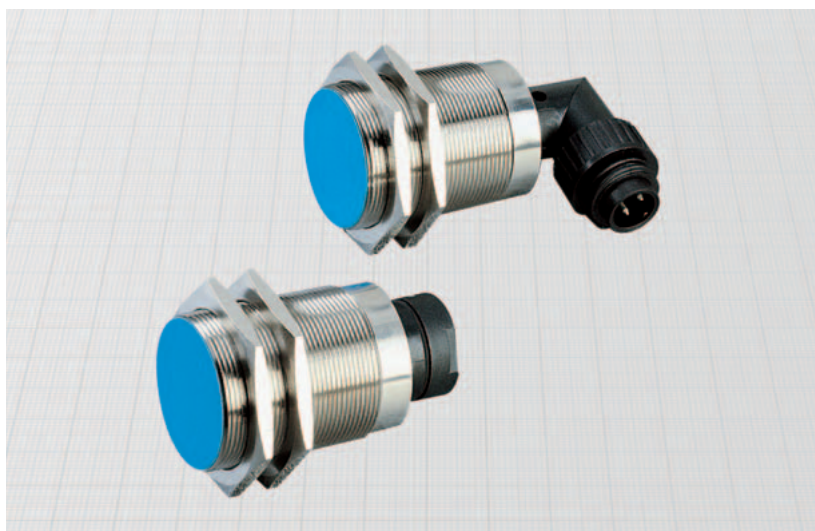

Diameter	M45 x 1,5	
Nut	Size	SW55
	Thickness mm	5
Max tightening torque Nm	70	

Materials:

- Housing: nickel plated brass
- Sensing face and socket connector: plastic

Technical data:

- Supply voltage (U_B): $7 \div 60$ Vdc
- Max ripple: 10%
- No-load supply current (I_0): ≤ 10 mA
- Voltage drop (U_d): $\leq 2,2$ V
- Temperature range: $-25^\circ \div +75^\circ$ C
- Max thermal drift of sensing distance S_T : $\pm 10\%$
- Repeat accuracy (R): 2%
- Switching hysteresis (H): 10%
- Degree of protection: IP65
- Switch status indicator: yellow LED
- Protected against short-circuit and overload
- Protected against any wrong connection
- Suppression of initial false impulse
- Electromagnetic compatibility (EMC) according to EN60947-5-2
- Shock and vibration resistance according to EN60068-2-27 EN60068-2-6

Housing	Flush mounting Non flush mounting	L1	L2	L3	L4	L5	Female connector	Body diameter (d)	Max switching frequency (f)	Rated operational current (I_e)	Nominal sensing distance (S_T) $\pm 10\%$	ORDERING REFERENCES		
												PNP (positive switching)		
M-2	•	-	50	10	42	102	1	M45 x 1,5	0,15	400	20			
												DCA45/4209KS	DCA45/4219KS	
												NPN (negative switching) Use the above mentioned part number changing the last number 9 with 8 (ie DCA45/4208KS)		
												PNP (positive switching)		
M-3	•	-	50	28	-	78	2	M45 x 1,5	0,15	400	20	DCA45/4E09KS	DCA45/4E19KS	DCA45/4E29KS
												NPN (negative switching) Use the above mentioned part number changing the last number 9 with 8 (ie DCA45/4E08KS)		